

Modulo 205

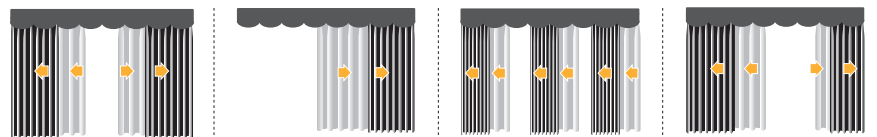

1.1.89

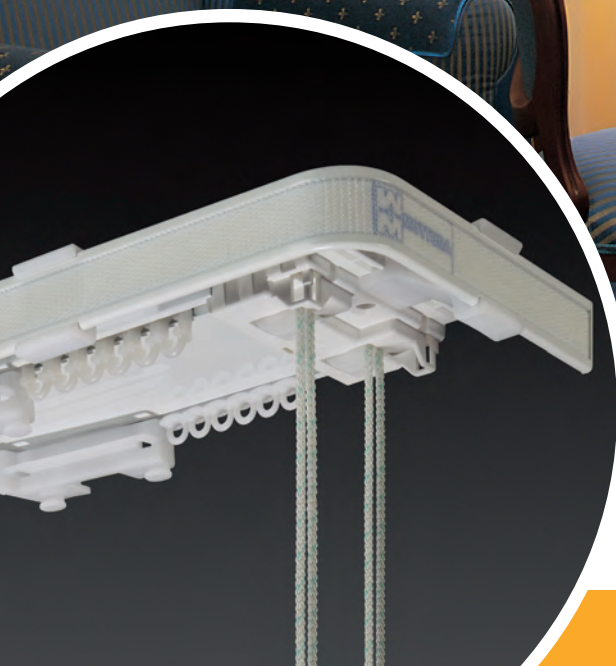



CARATTERISTICHE TECNICHE - SPECIFICATIONS
CARACTERÍSTICAS - CARACTERÍSTICAS - CARACTÉRISTIQUES
EIGENSCHAFTEN - KARAKTERISTIEKEN - ХАРАКТЕРИСТИКИ

- Profilo in lega d'alluminio estrusa 6060 T6 UNI 8278
 - Larghezza 94 mm; Altezza 10,2 mm
 - Canali di scorrimento 6 mm
 - Interasse tra i canali: 70 mm
 - Finitura superficiale: verniciatura poliester bianco RAL 9016.
 - Carrucole in termoplastico antiurto con ruote su perni in acciaio
 - Accessori in acetilica autolubrificante
- 6060 T6 UNI 8278 extruded aluminium alloy track
 - Length 94 mm; Height 10,2 mm
 - Sliding channels 6 mm
 - Centre distance between channels: 70 mm
 - Surface finish: RAL 9016 white: polyester paint
 - Shockproof thermoplastic pulleys with wheels on steel journals
 - Self-lubricating acetylic accessories
- Perfil en aleación de aluminio extruido 6060 T6 UNI 8278
 - Anchura 94 mm - Altura 10,2 mm
 - Canal de deslizamiento 6 mm - Distancia entre los canales: 70 mm
 - Acabado de la superficie: pintura poliéster blanca RAL 9016.
 - Polea en termoplástico endurecido con ruedas sobre ejes de acero
 - Accesorios de acetálico autolubrificante
- Perfil de liga de alumínio extrudido 6060 T6 UNI 8278
 - Largura 94 mm; Altura 10,2 mm
 - Calhas de deslizamento 6 mm
 - Distância entre as calhas: 70 mm
 - Acabamento superficial: tinta de poliéster branca RAL 9016.
 - Polias de material termoplástico anti-choque com rodas aplicadas em pernos de aço
 - Acessórios de resina acetálica autolubrificante
- Profil en alliage d'aluminium extrudé 6060 T6 UNI 8278
 - Largeur 94 mm; Hauteur 10,2 mm
 - Rails de coulissement 6 mm - Entraxe entre les rails: 70 mm
 - Finition superficielle: peinture polyester blanc RAL 9016.
 - Poulies en matériau thermoplastique antichoc avec roues sur pivots en acier
 - Accessoires en résine d'acétal autolubrifiante
- Profil aus extrudierter Alu-Legierung 6060 T6 UNI 8278
 - Breite 94 mm; Höhe 10,2 mm - Laufkanäle 6 mm
 - Achsabstand zwischen den Kanälen: 70 mm
 - Oberflächen-Finish: Polyesterlackierung Weiß RAL 9016
 - Umlenkungen aus stoßfestem Thermoplast mit Rollen auf Stahlbolzen
 - Zubehör aus selbstschmierendem Acetal
- 6060 T6 UNI 8278 geëxtrudeerd aluminium profiel
 - Breedte 94 mm - hoogte 10,2 mm - Kanaalbreedte 6 mm
 - Afstand tussen de kanalen: 70 mm
 - Afwerking: RAL 9016 wit polyester lak.
 - Schokbestendige thermoplastic poelies met wielen op metalen as
- Профиль из экструдированного алюминиевого сплава 6060 T6 UNI 8278
 - Ширина 94 мм; Высота 10,2 мм
 - Желоба 6 мм
 - Межосевое расстояние между желобами 70 мм
 - Отделка поверхности: полиэфирная окраска в белый цвет RAL 9016.
 - Шкивы из противоударного термопласта с колесами на стальных осях
 - Принадлежности из самосмазывающейся ацеталовой пластмассы

INSTALLAZIONE

INSTALLATION
INSTALACIÓN
INSTALAÇÃO
INSTALLATION
INSTALLATION
INSTALLATIE
УСТАНОВКА

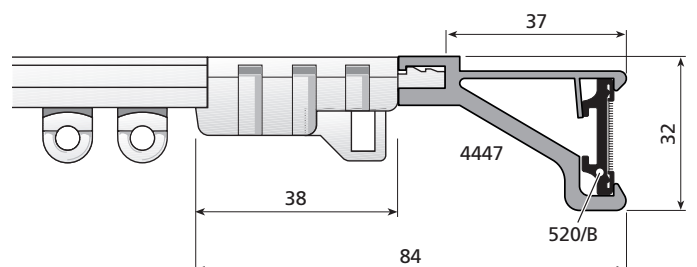
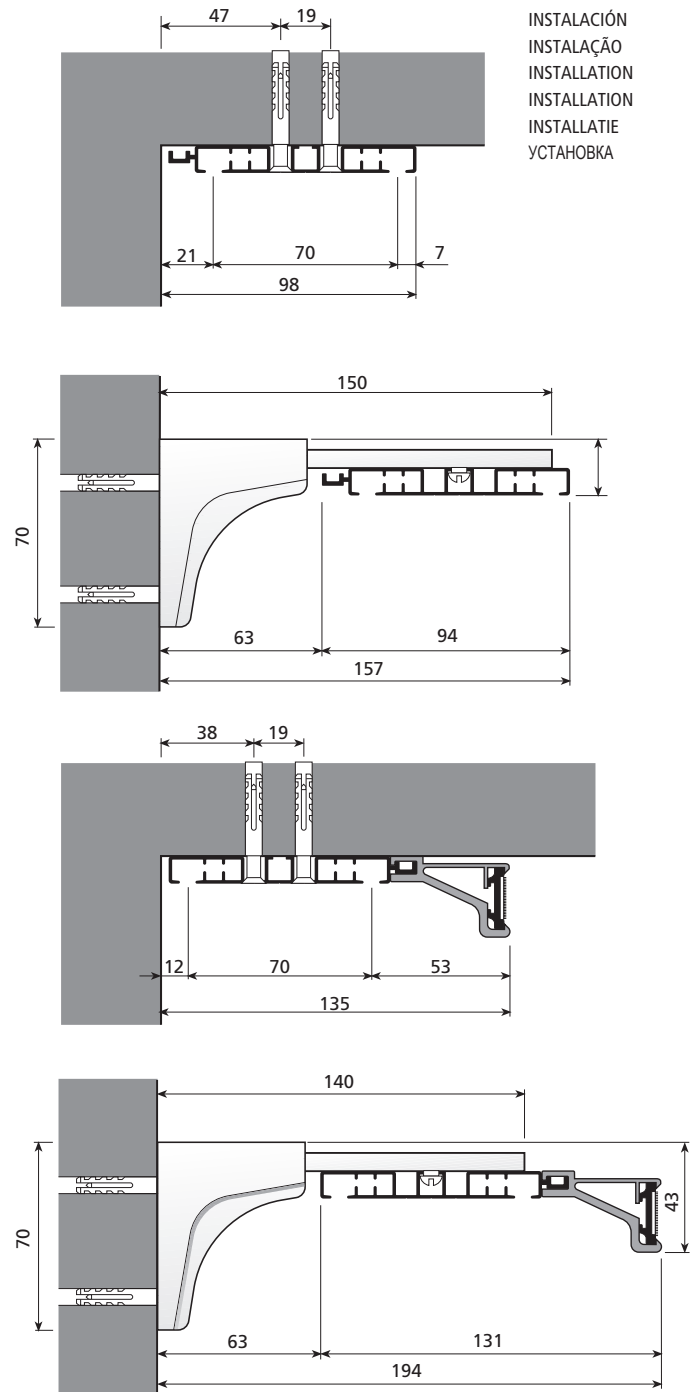



1.1.92

Modulo 205

UTILIZZO

USE
USO
USO
UTILISATION
ANWENDUNG
GEBRUIK
ИСПОЛЬЗОВАНИЕ

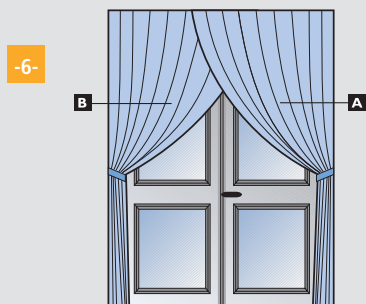
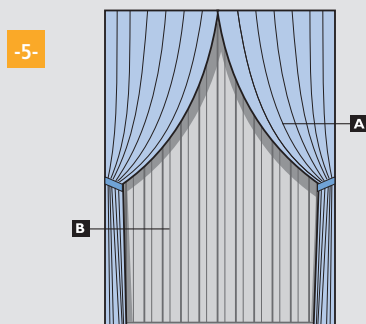
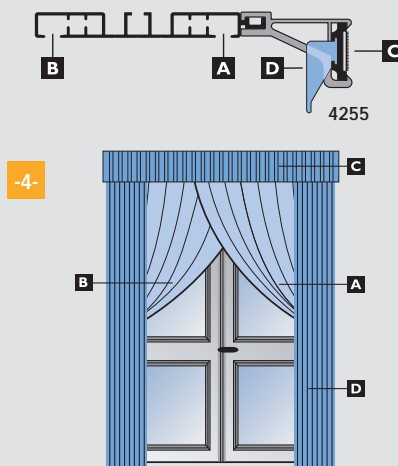
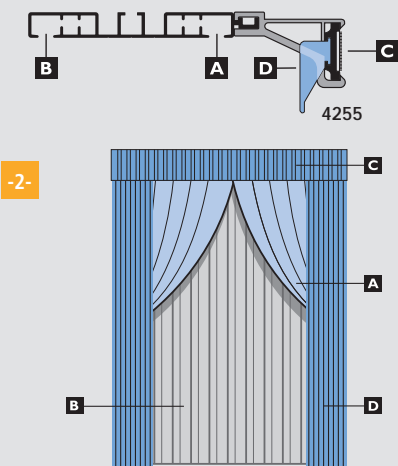
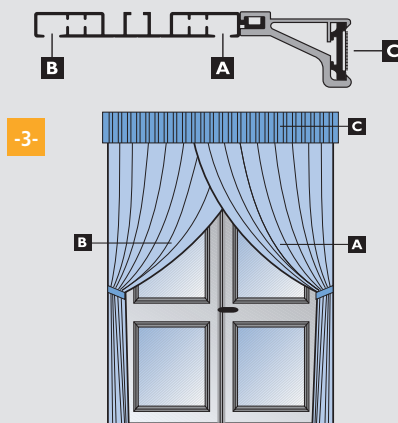
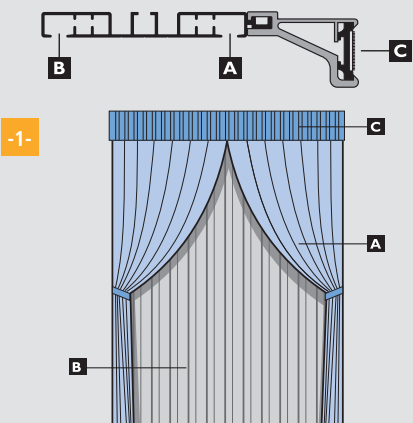

CONFEZIONI CONSIGLIATE

A RAPPORTO DI ARRICCIATURA
THE SPACE BETWEEN THE PLEATS
RAPPORT DE FRUNCIDO
RELAÇÃO DE FRANZIDO
INDIQUE LA DISTANCE ENTRE PLUS
GIBT DEN RAFFRAPPORT AN
GEEFT DE AFSTAND TUSSEN DE PLOOIEN AAN
ВИД ДРАПИРОВКИ

SUGGESTED STYLES OF CURTAINS
TIPOS DE CONFECCIÓN
TIPOS DE CORTINAS ACONSELHADOS
CONFECTION CONSEILLÉE
EMPFOHLENE VORHANGBÄNDER
AANBEVOLEN CONFECTIE
МОДЕЛЬ

B NASTRO - TAPE
CINTA - FITA
GALON - BAND
ЛИНТА - ЛЕНТА

	A	B
	1:2	art. 768 - h 30 mm
	1:2	art. 768 - h 30 mm

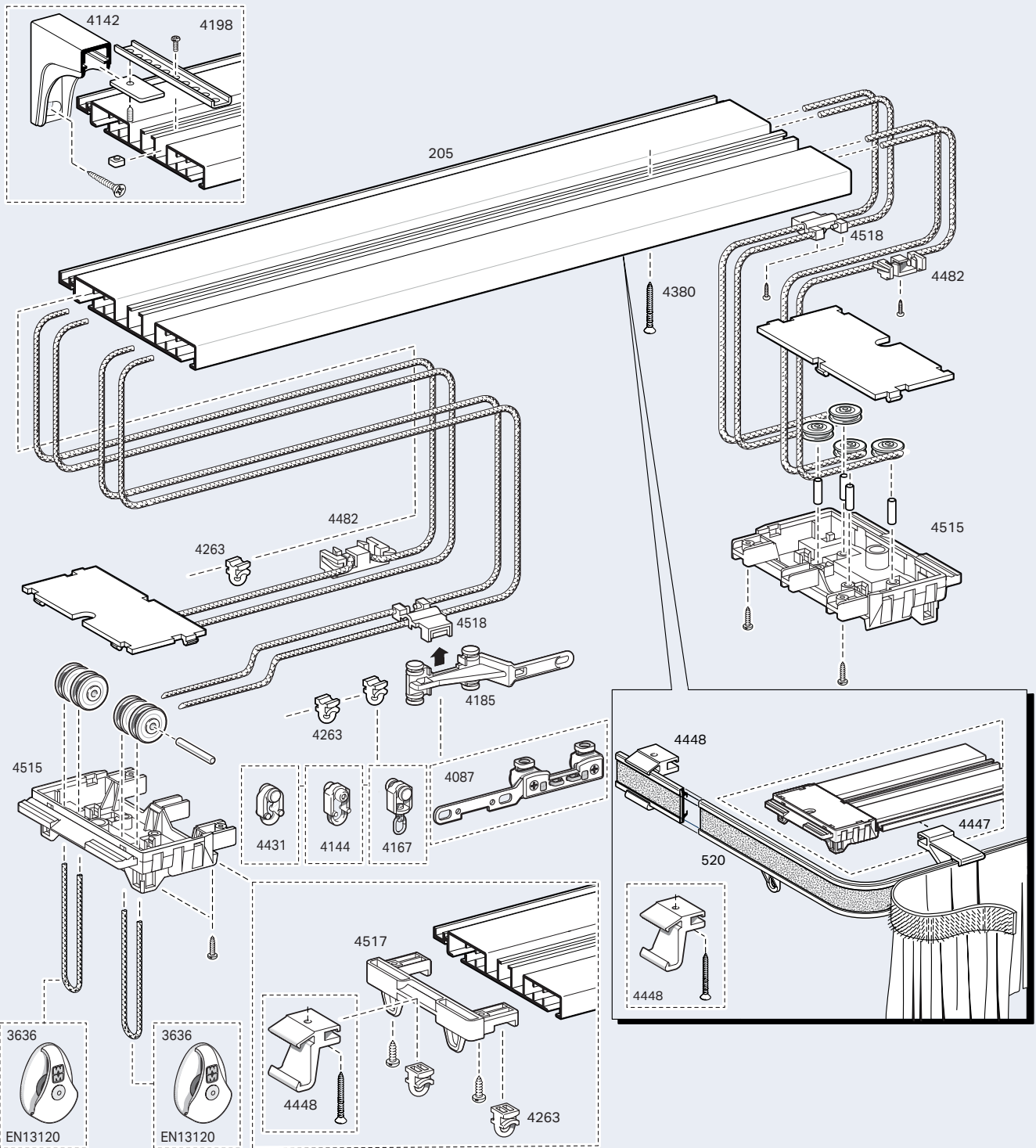

ANGOLI

ANGLES
 ANGULOS
 ÂNGULOS
 ANGLES
 WINKEL
 HOEKEN
 УГОЛ

